



SOFTWARE SUPPORT

WINDOWS 8

Installing unsigned drivers in Windows 8

- 1 Press and hold  +  to launch the charm bar.
- 2 Hold the  button (Shift) and restart the computer.

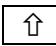
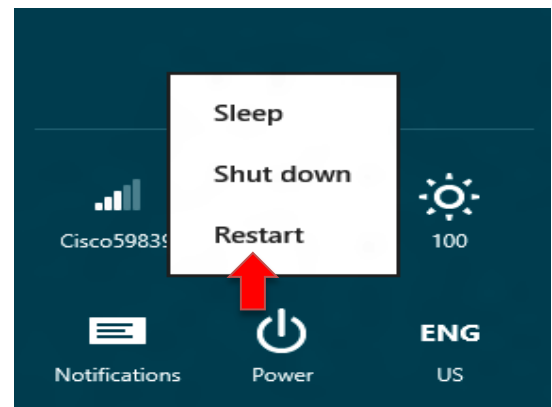

- 3 Choose "Troubleshoot".

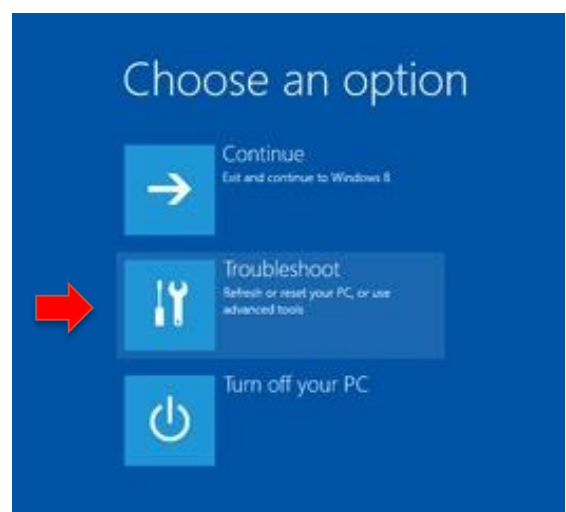

4 Click on "Advanced options".

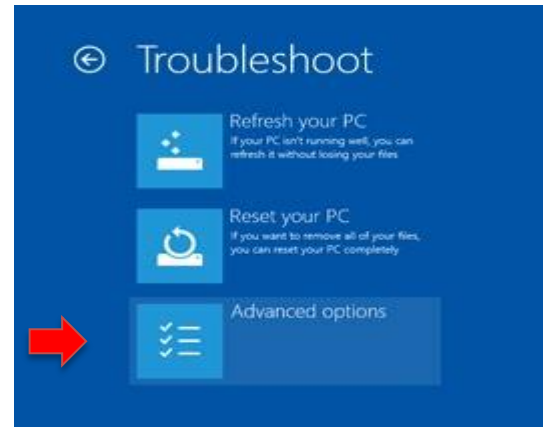

5 Choose "Startup Settings".

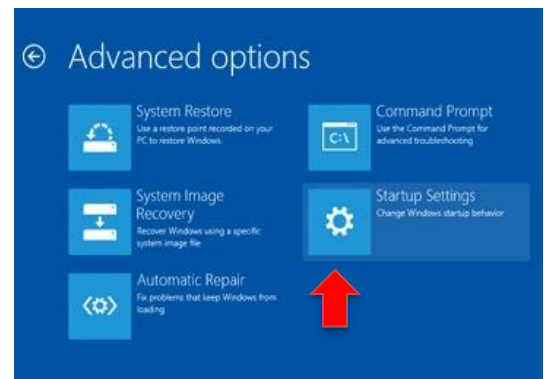

6 Now press "Restart".



- 7 Upon startup you will be given a bunch of options to choose from.

Press 7 on your keyboard to boot into Windows 8 with the driver signature check disabled.

Startup Settings

Press a number to choose from the options below:

Use number keys or functions keys F1-F9.

- 1) Enable debugging
- 2) Enable boot logging
- 3) Enable low-resolution video
- 4) Enable Safe Mode
- 5) Enable Safe Mode with Networking
- 6) Enable Safe Mode with Command Prompt
- 7) Disable driver signature enforcement
- 8) Disable early launch anti-malware protection
- 9) Disable automatic restart after failure

- 8 During installation, you are advised that the driver is not safe.

Press: "Install this driver software anyway".

